



www.Zricks.com





ZRICKS



ZRICKS

www.Zricks.com





RENTAL



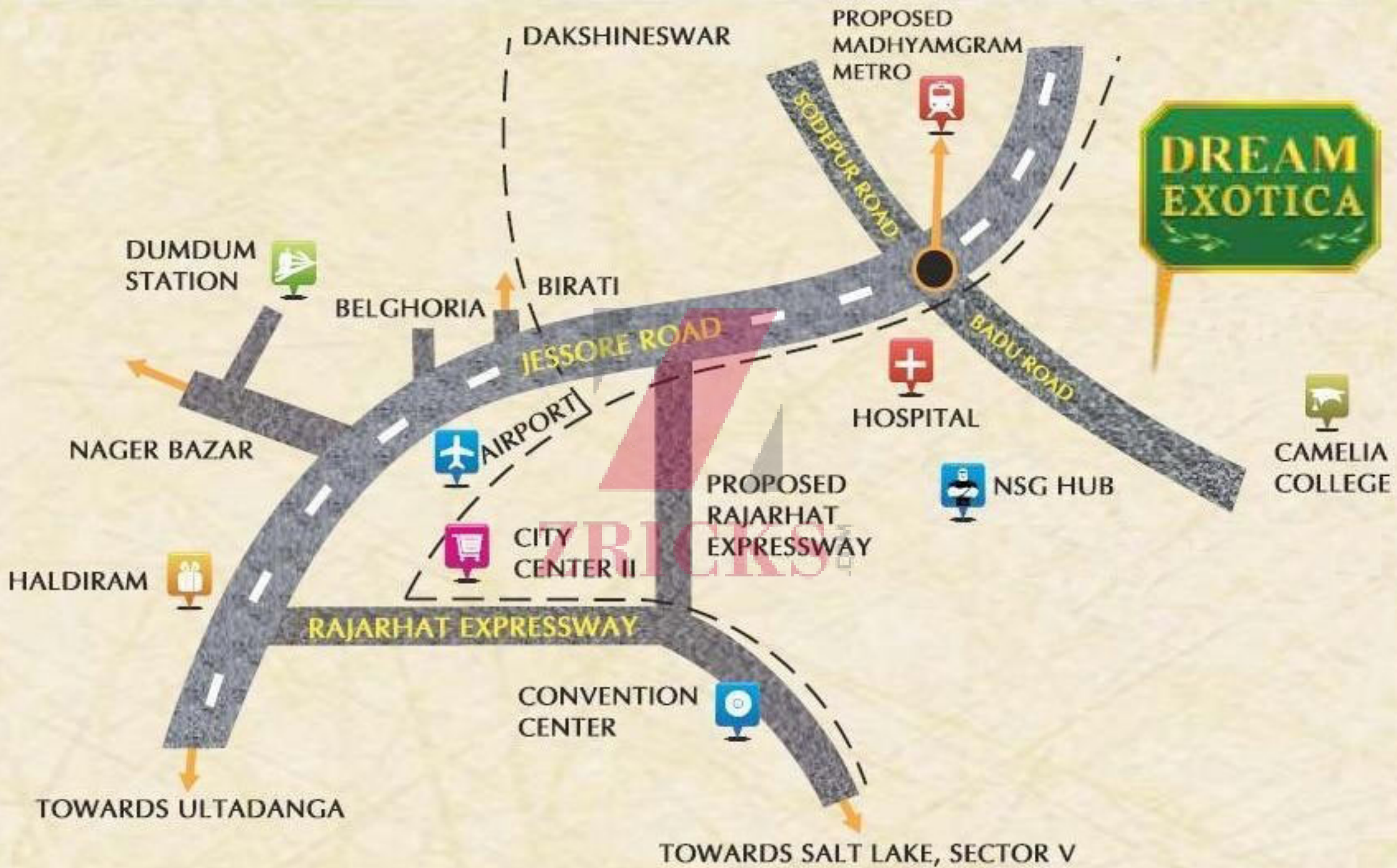

FLOOR PLANS

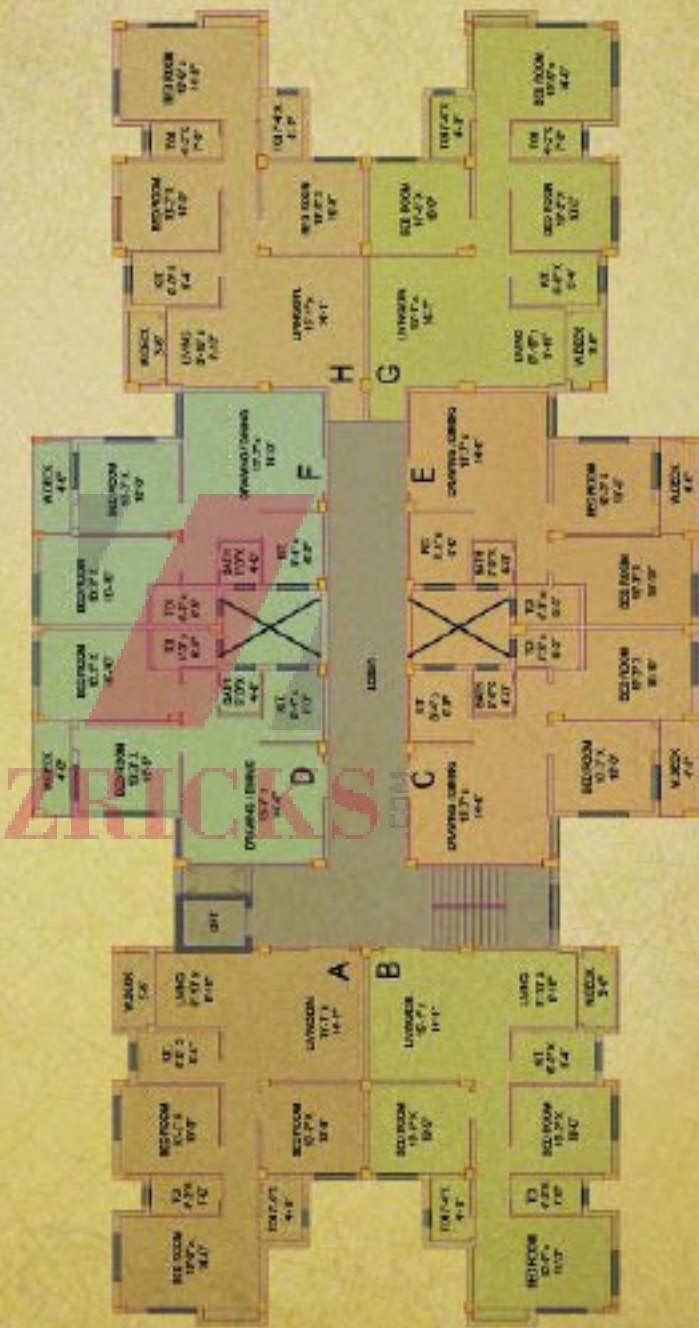

BLOCK 1

TYPE	RISK	AREA (in Sq Ft)
A	3	1230-1390
B	3	1225
C	2	900
D	2	900
E	2	895
F	2	895
G	3	1230
H	3	1230-1415

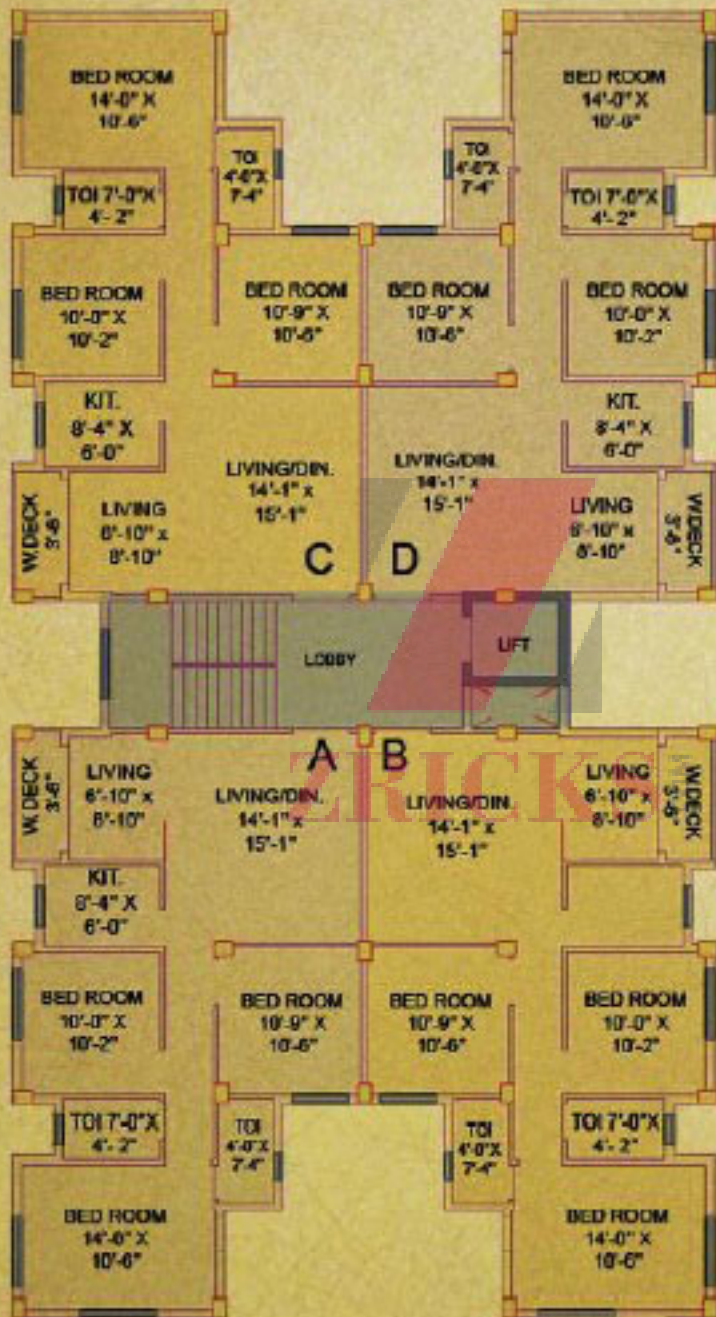

BLOCK 2

TYPE	BHK	AREA (in Sq Ft)
A	3	1220-1320
B	3	1220-1320
C	3	1220
D	3	1215

FLOOR PLANS

BLOCK 3

TYPE	BHK	AREA (in Sq Ft)
A	3	1215-1305
B	3	1220-1325
C	2	955
D	2	955

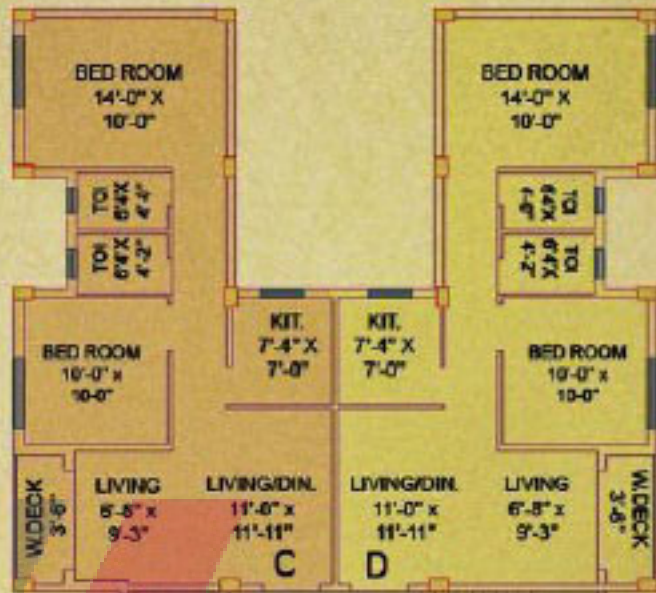

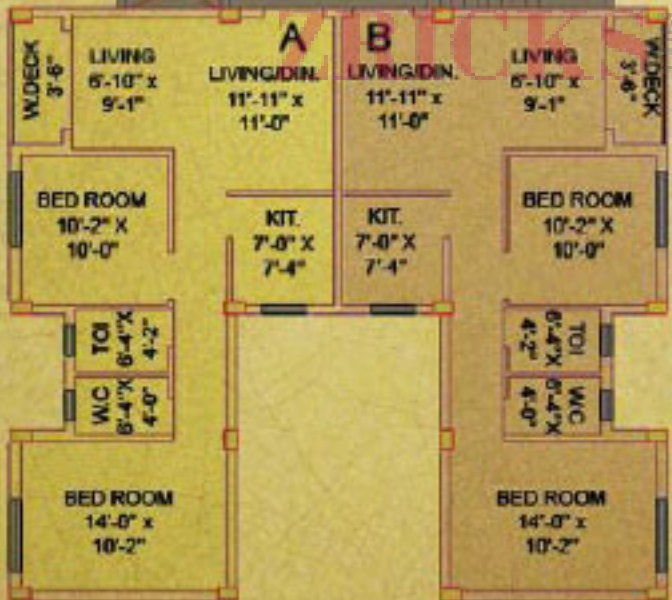
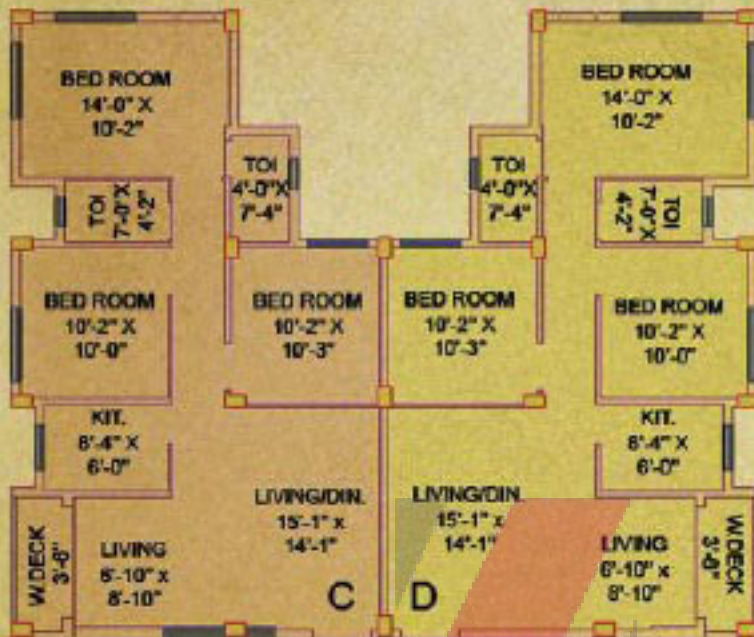

BLOCK 4

TYPE	RISK	AREA (in Sq Ft)
A	2	955
B	2	955
C	3	1215-1305
D	3	1220-1330

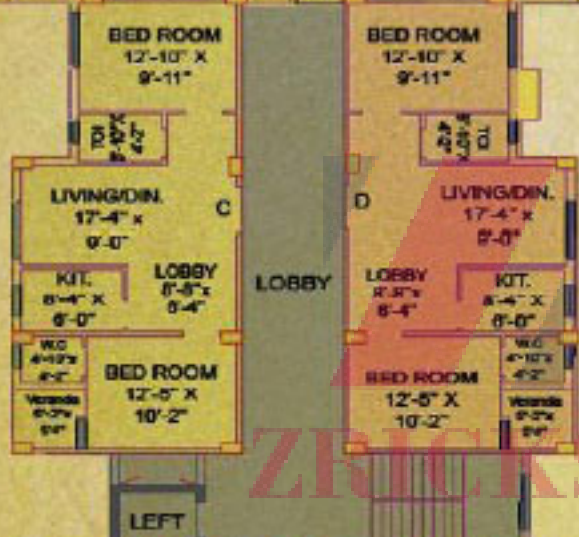
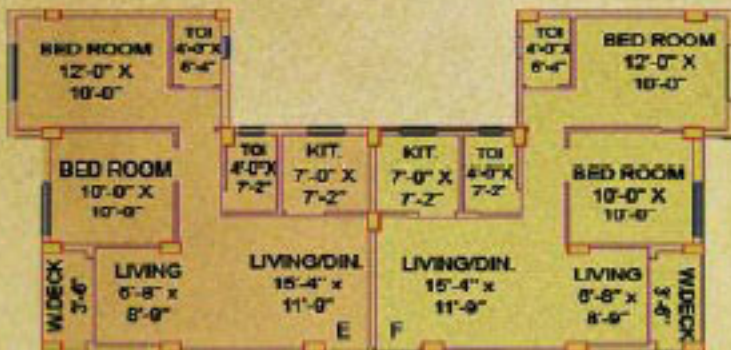

BLOCK 6

TYPE	BHK	AREA (in Sq Ft)
A	3	1215
B	3	1220
C	2	915
D	2	915
E	2	955
F	2	955



FLOOR PLANS

BLOCK 7

TYPE	BKSK	AREA (in Sq Ft)
A	2	955
B	2	960
C	3	1220
D	3	1220



GROUND FLOOR PLANS



BLOCK 2

TYPE	BEK	ARBA (In Sq Ft)
A	1	550
B	1	580
C	1	580
D	1	550



BLOCK 3

TYPE	BEK	ARBA (In Sq Ft)
A	1	550
B	1	580
C	1	580
D	1	510
E	1	595
F	1	505

Structure: RCC frame structure

Elevation: A mixture of modern design and conventional wisdom reflecting Singapore lifestyle

Exterior: Weather proof paint and decorative finish

Interior Finish: Smooth Plaster of Paris wall finish

Flooring: Quality Vitrified tiles in Living, Dining, Kitchen & all Bedrooms

Staircase and Lobby: Wide spacious staircase, elegantly designed lobby & corridors with high quality marble kota/granite stone

Kitchen: Granite top platform with stainless steel sink of reputed make, glazed tiles, dado upto 2 feet height above the platform

Electric and Voice/Data points: Copper wiring , MCB of Havells or equivalent make, A.C. point in Master bedroom/Telephone, TV Cable point in living/dining/Geysers point in bathroom/Adequate light and fan points / Modular switches

Water Supply: 24 hours interrupted treated water supply

Lift: High quality lifts in each block

Toilet : Elegant CP fittings, Anti skid tiles on the floor and walls upto door height, hot and cold water plumbing, Western style sanitary fittings

Windows: Sliding premium finish Powder Coated Aluminum.

Doors: Entrance-polished flush doors with night latch. Good quality flush doors in all other rooms

Hardware: Brass & stainless steel hardware fittings of reputed make.